

# Wireless automatic door switch for disabled (WHD)

## Instruction Manual

Thank you for purchasing the WHD switch. This switch is to be installed in equipment requiring a relay contact. The WHD switch was designed to easily open an automatic door for pedestrians who require assistance, for example the elderly, the disabled or pregnant women.



## 1 SPECIFICATIONS

Set	Receiver (WHD1)	1		
	Internal Switch (WHD2) / External Switch (WHD3)	1 Each		
	Power Connector (Gray)	1		
	Output Contact Connector (Yellow)	1		
	3M Sticker	4		
	AA Size Battery	8 X 1.5V AA size		
	Manual	1Copy		
Spec	Receiver (WHD1)		Internal Switch (WHD2) / External Switch (WHD3)	
	Power	DC12-30V/AC12-24V	Rated frequency	FM 433.92MHz or 447.60MHz
	Relay Contact capacity	1A/30VDC, 0.5A/125VDC	Battery	1.5V AA 4EA Each
	Operating Temp	-20°C ~ 50°C	Operating Temp	-20°C ~ 50°C
	Product Size	150×43×25mm	Product Size	135×135×19mm
	Current Consumption	Standby : 30mA / Action : 80mA (DC 24V)	International Protection	IP54 (Waterproof)

## 2 General Information

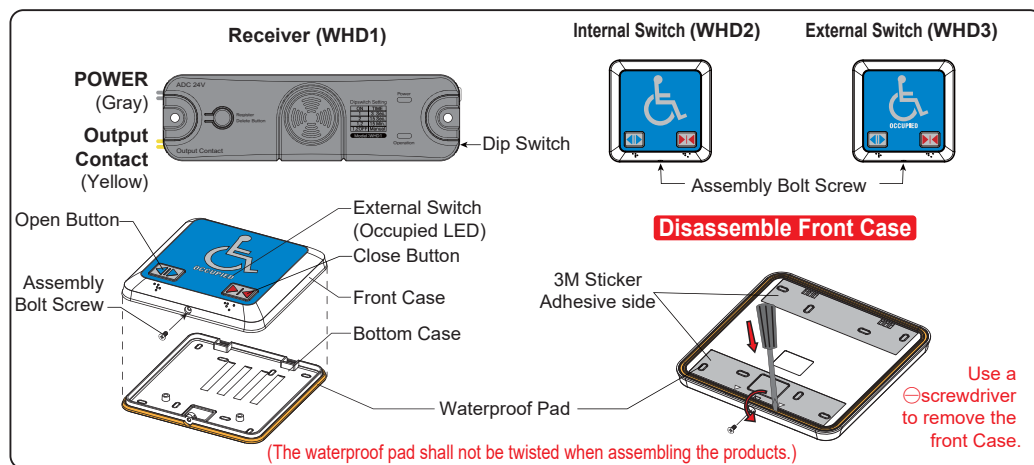

## 3 OPERATION CHECK & CAUTION

- 1) Input **DC12-30V/ AC12V-24V** for power supply. Make sure Power LED is on.
- 2) Put AA size battery into Internal & External switches.
- 3) **Please register Internal & External switch to receiver.**
- 4) Ensure the Receiver (WHD1) is wired correctly.
- 5) **Immediately change batteries when aural alert is heard.**
- 6) Although the WHD2 / WHD3 switches are IP54 water resistant, excessive water cleaning can cause damage to the internal components

## 4 USER MANUAL

※Default: Transmitters (WHD2/ WHD3) are registered.

### 1) ID Register

Please press and hold an open or close button on either transmitter(WHD2/ WHD3) for 5 seconds while pressing and holding the Register/Delete button on the receiver. When pairing has been successful, WHD1 will loudly announce **"DOOR IS OPENING"**

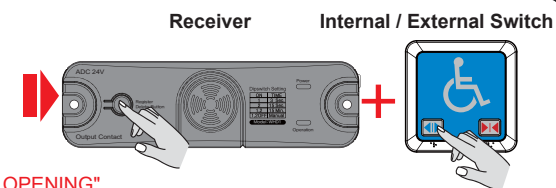

### 2) ID Delete

Press and hold Register/Delete button on the receiver for minimum 10 seconds, successful deletion will be notified via a **buzzer sound**.

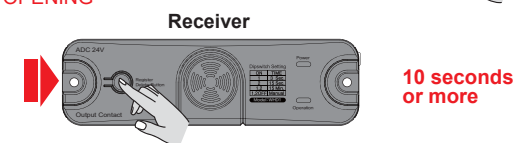

3) Press **OPEN DOOR** symbol on external switch to enter. Once inside, press **CLOSE DOOR** symbol to lock the door. The **OCCUPIED** sign will illuminate on the external switch if entry is attempted at this time.

4) Holding the **OPEN DOOR** symbol on the external switch for 10 seconds will open the door. (In case of emergency)



5) User can adjust door closing time (Relay contact time)

Dip Switch	Time	Dip Switch	Time
	After 3 sec, close the door		After 15 min, close the door
	After 15 sec, close the door		Manual (Default): act by pressing button

6) Voice language selection

Dip Switch (Default : ENG)			
	: KOR		: BEEP
	: ENG		: MUTE

**⚠ For internal user's safety, the door can be opened by an external user 30 minutes after the door has been closed from the inside.**

## 5 EXTERNAL DIMENSIONS

